

# Possible Hike 01

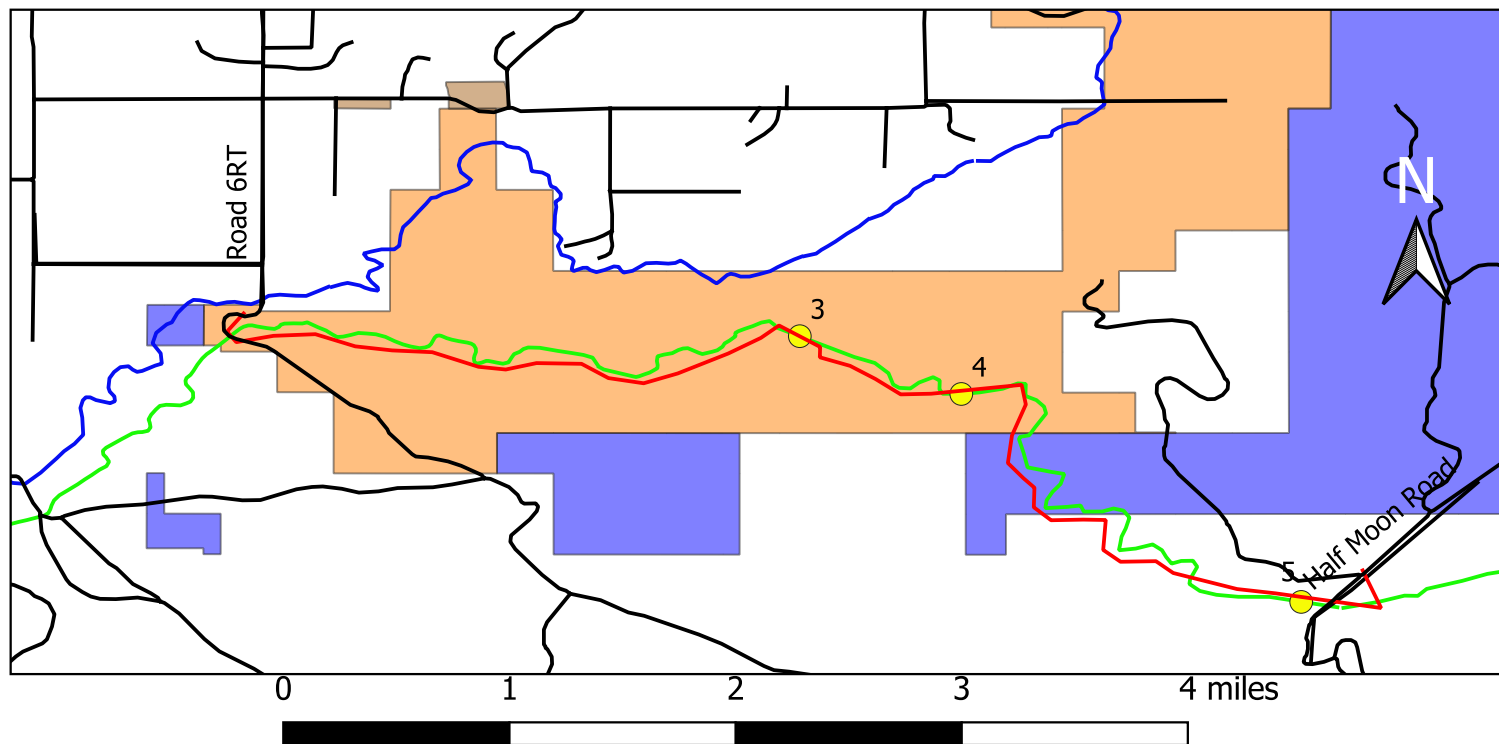

This map shows a possible hike to visit Tunnels 3 through 5 of the Wiley Canal. The route shown as Possible Hike 01 (red line) is 7.12 miles long. It begins on BLM land just off the south end of Road 6RT Spur and ends on Hoodoo Ranch property on the road to the Half Moon oil field at about the location of the sign prohibiting further travel to the south.

The 1987 Irma Flats USGS 7.5-minute quad and Google Earth show a two-track road going over Tunnel 3 (approximate location 44.40912, -109.14042). This map preparer does not know how to best access that road or its condition. Accessing this road will require crossing private land.

Files including KML files for the possible hike, the Wiley Canal, and the five tunnels, along with an image from Google Earth showing the area as well as an elevation profile are available at <[https://inlandwyo.com/pub/Hikes/2023-06-\\_\\_Wiley\\_Canal\\_Tunnels/](https://inlandwyo.com/pub/Hikes/2023-06-__Wiley_Canal_Tunnels/)>. There is also a marked rendition of the 1987 Irma Flats quad as a PDF.

A scouting trip to the west end of the possible hike on 22 June found that in places the canal bottom is smooth and open (being used by four-wheel vehicles in some areas) and in other places it is full of healthy sagebrush. Such conditions are likely to exist throughout the route.

